

FRIALEN® Transition Elbows 90° HD-PE/Brass with male thread* WUN 90°

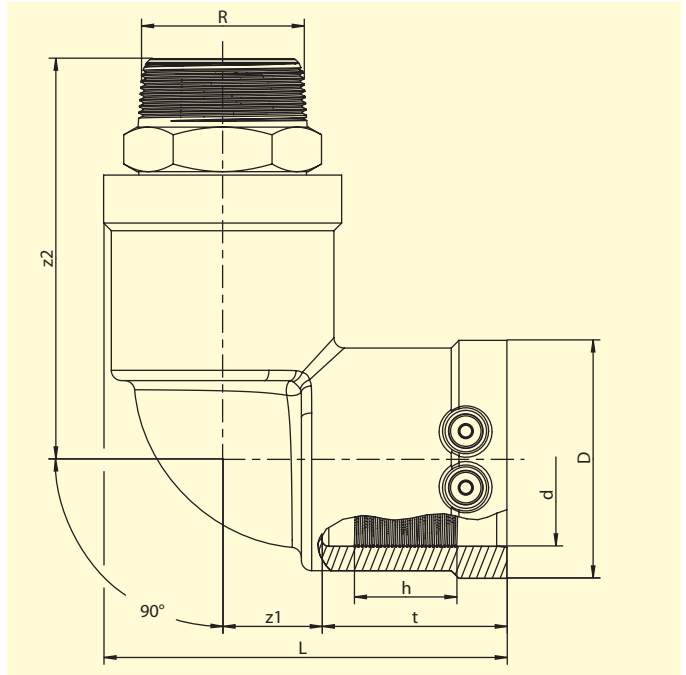

PE 100 SDR 11

Maximum working pressure 16 bar (water)



d	R	Order Ref.	Stock-status	BX	PU	D	L	t	h	z1	z2	Weight kg/each
32	1"	612120	1	20	1000	47	85	42	23.5	21	89	0,320
32	1 1/2"	612140	1	20	1000	47	94	42	23.5	21	93	0,470
40	1"	612127	1	15	750	58	102	45,5	30	27	101	0,480
40	1 1/4"	612122	1	15	750	58	102	45,5	30	27	103	0,520
40	1 1/2"	612121	1	15	750	58	102	45,5	30	27	104	0,580
50	1"	612119	1	10	500	70	118	53	29.8	30	110	0,640
50	1 1/4"	612123	1	10	500	70	118	53	29.8	30	112	0,670
50	1 1/2"	612124	1	10	500	70	118	53	29.8	30	113	0,680
63	1 1/2"	612125	1	10	320	84	128	53	35	33	116	0,980
63	2"	612126	1	10	320	84	128	53	35	33	121	1,000

Other thread sizes on request

FRIALEN safety fittings can be fused to pipes SDR11 - SDR 17.6, minimum wall thickness $s_{min} \geq 2,3$ mm. Other SDR-stages on request. Please observe the marking directly at the product, which is mandatory. DVGW-Registration Nos. DV-8601AU2248 and DV-8606AU2249

* Standard: Brass. Gunmetal and V2A on request

FRIALEN® Transition Elbows 90° HD-PE/Brass with male thread* WUN 90°

Areas of Application

FRIALEN-Transition Elbows WUN 90° are threaded joints as an adaptor from a metal pipe with internal thread to a HDPE pipe. Joint on the part of HDPE by FRIALEN-Coupler.

Assembly Instructions

The threaded component must be held with a spanner to prevent it twisting in the HDPE component. The fusion of the HDPE side takes place by FRIALEN-fusing – leakproof and longitudinally strong.

The installation of the brass and the HDPE side has to be prepared according to the general installation instructions (see "Transition Fittings with threaded connection" in "Assembly Instructions" for "FRIALEN-Safety Fittings for house connections and distribution pipes up to d 225"). This involves removing the oxide skin and cleaning the pipe ends.

Eight good reasons for using the FRIALEN-Transition Elbows WUN 90°:

- **Compact construction**
- **HDPE side with exposed heating element for optimal heat transfer**
- **Cold zones at the end to prevent the flow of molten material**
- **No holding clamps required**
- **Large insertion depth, extra wide fusion zones**
- **Brass end permanently anchored in the HDPE and will not distort**
- **Self sealing patented sealing geometry without elastomer seal**
- **Additional barcode for tracing back the fitting (Traceability-Coding)**

For further information, please call our customer service staff and specialist advisers.

FRIATEC Aktiengesellschaft · Technical Plastics Division
P.O.B. 71 02 61 · D-68222 Mannheim
Telephone +49 621 486-1431 · Telefax +49 621 479196
www.friatec.com · E-Mail: info-frialen@friatec.de

Please find our datasheets for downloading on the internet at www.friatec.com