



PRODUCT/TECHNICAL G0024/1

EXCEL 3^C WITH TOWING HEAD
COMPLETE CLEAN BORE SOLUTION

For installation without pre-chlorination



www.gpsuk.com

Reduced installation time

Truly clean bore
throughout
installation

No towing
head failures



Our Excel 3^c pipe coil eliminates the need for lengthy on site pre-chlorination, reducing installation costs, disruption and chemical waste. With the introduction of our new integral Towing Head, the pipe bore remains clean throughout the whole installation process and the risk of a towing head failure is minimised.

Excel 3^c (Clean, Capped, Coiled) Pipe

Excel 3^c is a unique patented factory clean PE100 pipe coil that is approved by the Secretary of State for installation without pre-chlorination. It allows installers to proceed to immediate installation, significantly reducing the overall installation time and costs. The factory-sealed pipe ends are secured by a protective cap and integral Towing Head, to ensure the pipe bore is doubly protected against possible contamination.

Excel 3^c is kinder to the environment, as it cuts down on the number of chlorination treatments required, reducing chemical usage and waste disposal of large volumes of disinfected water.

Features

- BS EN 12201 / WIS 4-32-17 compliant pipe
- Factory-sealed pipe ends
- Factory-clean pipe bores when delivered to site
- Secured by a protective cap at one end and a cap or integral Towing Head – at another
- Regulations 31 and 27 approved coils for installation without pre-chlorination
- Six-month storage life after which it may be installed as a standard PE100 pipe coil
- Patented technology

Benefits

- Immediate installation from stock, without lengthy pre-chlorination
- Less disruption to water supply
- Higher installation productivity compared with unsealed coils
- Significant installation cost savings
- Kinder to the environment with reduced chlorine use
- Fewer visits to site needed – reduced traffic disruption
- Post-installation sterilisation for 30 minutes contact only – industry recognised methodology.



Towing Head

Excel 3° pipe can be supplied complete with a factory fitted Towing Head, ready to be attached to a towing shackle for immediate installation. Unlike most conventional detachable towing heads, the GPS Towing Head is integral to the pipe. This removes the risk of installation failure resulting from the towing head being pulled away and ensures that the pipe stays sealed from the point of manufacture and throughout the whole installation process.

A fast, simple and extremely reliable method of attaching a pulling device to a plastic pipe, the GPS Towing Head lowers overall installation costs by reducing installation time and the risk of a towing head installation failure.

Features

- Safe and robust design – the weld's yield strength is greater than the pipe's yield strength
- Factory welded onto the pipe for complete integrity
- Excel 3° pipe remains completely sealed from factory to installation
- No on site preparation required – just hook the shackle
- No additional fixtures or fittings required
- Manufactured in PE100
- Suitable for all installation techniques where a towing head is required
- Patent pending

Benefits

- Ease of use
- Reduction in installation time
- No installation failure due to towing head detaching from pipe
- Cost savings due to reduced installation time and improved productivity
- No risk of contamination from the ingress of water or debris

Three Simple Steps

Standard PE coils require pre-chlorination, flushing and fitting of a towing head attachment suitable for the application. Excel 3° with Towing Head negates all of these extra steps, saving up to a week in preparation prior to installation:

- 1. Select correct size of Excel 3° with Towing Head**
- 2. Attach a shackle* to the Towing Head and install**
- 3. Following installation, remove the Towing Head together with 20cm of pipe before post-installation sterilisation and final connection to the water supply**

* A standard square head D shackle should be used (see the table overleaf for recommended shackle sizes).

GPS Towing Head is non-reusable. To maintain clean and hygienic pipe bore, it must be welded onto Excel 3° pipe during the production process at the factory.



Product Codes and Dimensions

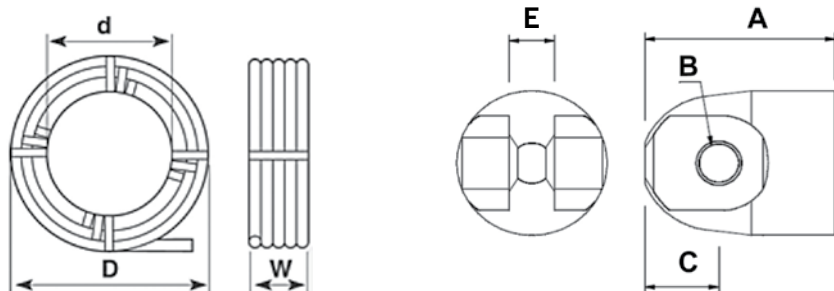

Excel 3° Coil – SDR11

Size (mm)	Length (m)	Product Code with Towing Head	Product Code without Towing Head	Mean Bore (mm)	d (mm)	D (mm)	W (mm)	Approx. Weight (kg)
90	50	41 850 313	41 845 313	72.9	1800	2360	360	106.0
	75	41 851 313	41 862 313			3080	380	157.0
	100	41 852 313	41 860 313			2540	450	212.0
110	50	41 850 314	41 845 314	89.1	2500	2700	450	160.0
	75	41 851 314	41 862 314			2900	450	235.0
	100	41 852 314	41 860 314			2900	570	318.0
125	50	41 850 315	41 845 315	101.3	2500	3000	500	204.0
	75	41 851 315	41 862 315			3200	450	302.0
	100	41 852 315	41 860 315			3250	560	408.0
160	50	Contact our Sales Office for further information	41 845 317	129.8	3000	3900	490	337.0
	75		41 862 317			3900	600	497.0
	100		41 860 317			3900	650	679.0
180	50		41 845 318	146.0	3000	3720	550	422.5
	75		41 862 318			3700	790	626.0
	100		41 860 318			3720	900	845.0

Excel 3° Coil – SDR17

Size (mm)	Length (m)	Product Code with Towing Head	Product Code without Towing Head	Mean Bore (mm)	d (mm)	D (mm)	W (mm)	Approx. Weight (kg)
90	50	41 853 313	41 846 313	78.7	2500	3100	270	69.5
	75	41 854 313	41 847 313			3080	380	108.0
	100	41 855 313	41 849 313			3300	360	139.0
110	50	41 853 314	41 846 314	96.3	2500	2800	450	104.0
	75	41 854 314	41 847 314			3200	500	162.0
	100	41 855 314	41 849 314			3100	570	206.0
125	50	41 853 315	41 846 315	109.5	2500	3500	400	133.0
	75	41 854 315	41 847 315			3200	450	204.0
	100	41 855 315	41 849 315			3750	500	266.0
160	50	41 853 317	41 846 317	140.3	3000	3900	490	220.0
	75	41 854 317	41 847 317			3900	600	337.0
	100	41 855 317	41 849 317			3900	650	438.0
180	50	41 853 318	41 846 318	158.0	3000	3720	550	274.5
	75	41 854 318	41 847 318			3700	790	423.0
	100	41 855 318	41 849 318			3720	900	549.0

Overall pipe dimensions are offered as guide only and do not include Towing Head dimensions (these are listed separately).

Towing Head

Size (mm)	A (mm)	B (mm)	C (mm)	E (mm)	Max Towing Load (tonnes) SDR11	Max Towing Load (tonnes) SDR17	Shackle Size (tonnes)
90	133	27	44	28	2.1	1.4	4.75
110	141	30	51	32	3.1	1.6	6.5
125	159	33	62	38	4.1	2.7	8.5
160	177	40	72.5	46	Contact our Sales Office	4.5	12.0
180	187	40	72.5	46		5.7	12.0

GPS PE Pipe Systems reserve the right to modify products without prior notice, as part of its programme of continuous improvement. The content of this publication is for general information only and it remains the users responsibility to determine the suitability of any product contained therein for the intended application. Whilst every effort is taken to ensure the accuracy of the information contained within the brochure, the details are offered in good faith and GPS PE Pipe Systems accepts no liability for matters arising as a result of errors and/or omissions. The product range displayed in this catalogue does not automatically indicate stock availability.

Please contact our Sales Office for specific details.
A PDF version of this brochure is available from our website at www.gpsuk.com.
Reproduction of this publication, or any part, is not permitted without the written consent of GPS PE Pipe Systems. Please contact our Marketing Communications Department via enquiries@gpsuk.com or Tel: +44 (0)1480 442623 for further information. GPS PE Pipe Systems is a trading name of Glynwed Pipe Systems Ltd. Company Number 1698059.



St Peter's Road, Huntingdon, PE29 7DA
Tel: +44 (0)1480 52121
Fax: +44 (0)1480 458829
Web: www.gpsuk.com
Email: enquiries@gpsuk.com
Twitter: GPS_PE_Pipes

